

BIO-CEL® L-2 Stack

Scope of Supply

The BIO-CEL® MBR product is ideal for biological wastewater treatment in industrial and municipal applications. This product specification sheet provides details about the standard scope of supply, available accessories and spare parts of BIO-CEL L-2 Stack modules.

Shipment dimensions and container transport information are detailed on page 2. BIO-CEL L-2 modules are shipped in cardboard. Part numbers in the below table are the standard scope of supply. For details about available accessories please refer to page 3. For spare parts please refer to page 5.

Please note that the second cassette and the connection parts are packed separately.

Table 1. Standard scope of supply

Part Number	Module Name	Comments
1000026500	BIO-CEL L-2 STACK	1.4301/304 (V2A), permeate port with G 2 ½ inner thread, air port with DN80 (PN10) pipe end in Polypropylene, incl. adjustable legs and connection set with all brackets, stiffeners screws and nuts
1000026501	BIO-CEL L-2 STACK SS316	1.4571/316Ti (V4A), permeate port with G 2 ½ inner thread, air port with DN80 (PN10) pipe end in Polypropylene, incl. adjustable legs and connection set with all brackets, stiffeners screws and nuts

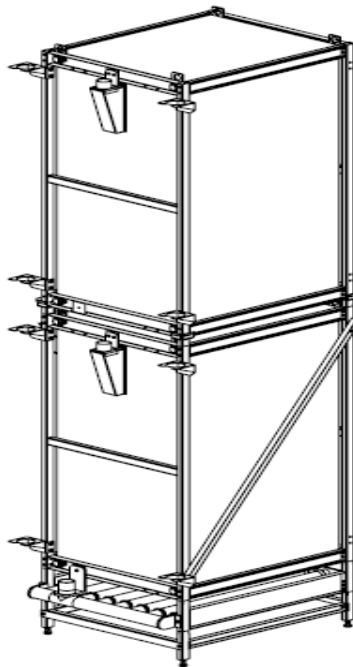

Figure 1. BIO-CEL L-2 Stack scope of supply

TECHNICAL BULLETIN - BIO-CEL L-2 STACK

BIO-CEL L-2 STACK packaging consists of three pieces, two carboards as shown in Figure 2 and one pallet with all additional connection parts in boxes. Depending on the number of BIO-CEL L-2 STACK modules ordered, all additional connection parts for more than just one module might be packed on one or more pallets project-specific.

Table 3 shows the arrangement in different container sizes for the carboards only.

Table 2. Cardboard shipment dimensions

	length	width	height	weight
BIO-CEL L-2	1,614 mm (5.3 ft)	1,136 mm (3.8 ft)	2,550 mm (8.4 ft)	425 kg (937 lb)

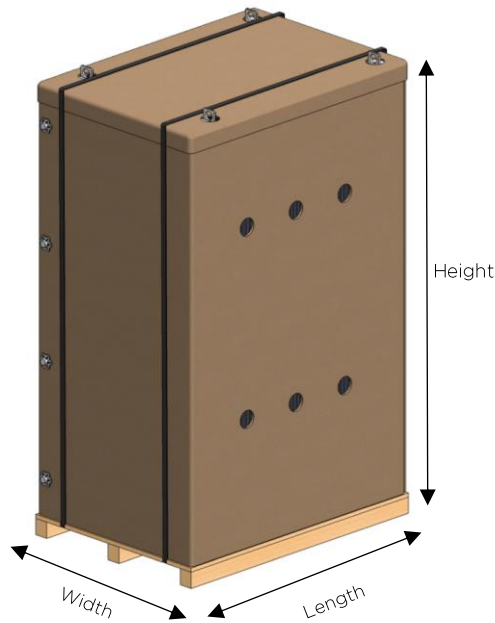

Figure 2. BIO-CEL L-2 in Transport packaging

Table 3. High cube container inner dimensions

	length	width	height
20 ft container	5,898 mm (19.4 ft)	2,350 mm (7.7 ft)	2,690 mm (8.8 ft)
40 ft container	12,032 mm (39.5 ft)	2,350 mm (7.7 ft)	2,700 mm (8.8 ft)
Door opening	-	2,350 mm (7.7 ft)	2,597 mm (8.5 ft)

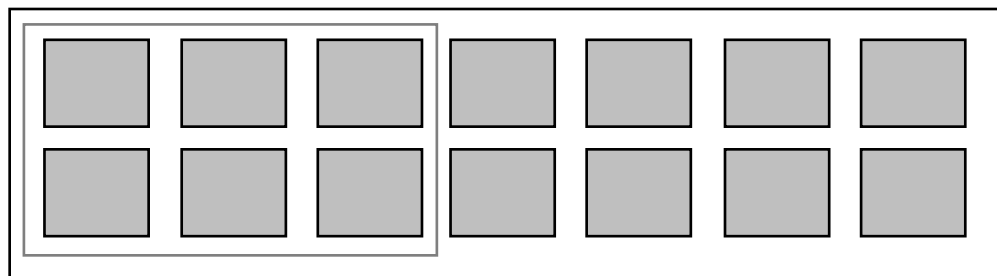

Figure 3. BIO-CEL L-2 arrangement in 20/40 ft HC container (6 / 14 pcs capacity)

BIO-CEL L-2 Accessories

To ensure proper installation and operation of BIO-CEL MBR modules, certain accessories may be necessary. Drawings of wall fixations, lifting & guiding system and hanging concepts can be sent on request.

Table 4. Accessories

Position	Part Number	Accessory	Material / Comment
A1	1000001433	BIO-CEL L-2 Lifting Tool	Stainless Steel 1.4301/304
A2	1000000679	BIO-CEL L-2 Air Port Flange Adapter	Polypropylene adapter to DN80 flange including DN80 Grip Clamp (Stainless Steel 1.4404/316L and EPDM sealing)

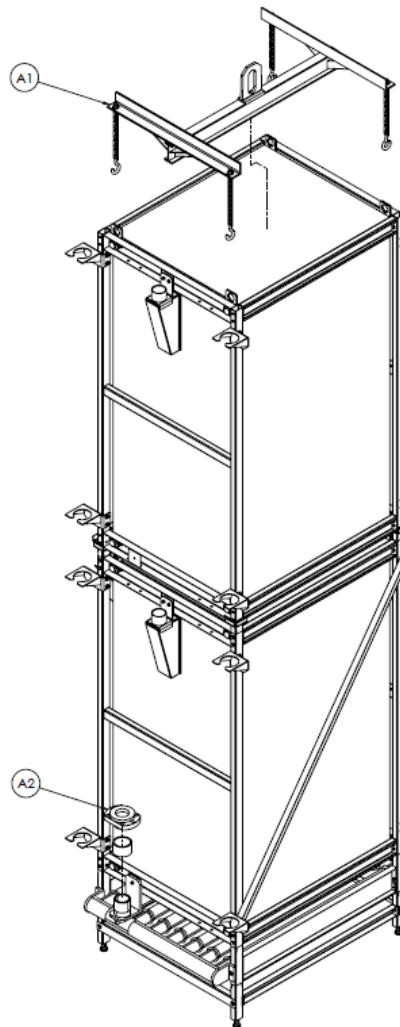

Figure 4. BIO-CEL L-2 Stack accessoires

BIO-CEL L-2

Spare Parts

No spare parts are typically required within the first 5 years of operation. If spare parts are needed, they may be ordered as per the table 5.

Table 5. Spare parts

Position	Part Number	Spare Part	Remarks
S1	1000001435	BIO-CEL L-2 Cassette	Stainless Steel 1.4301/304 (V2A)
	1000001467	BIO-CEL L-2 Cassette SS316	Stainless Steel 1.4571/316Ti (V4A)
S2	1000001436	BIO-CEL L-2 Permeate Block Standard	1.4301/304 (V2A), permeate port with G 2 ½ inner thread
	1000022956	BIO-CEL L-2 Permeate Block Standard SS316	1.4571/316Ti (V4A), permeate port with G 2 ½ inner thread
S3	1000001438	BIO-CEL L-2 Diffuser GRID Incl. Diffuser Hoses	Polypropylene (Grid) Silicone (Hoses)
S4	1000001470	BIO-CEL L-2 Diffuser Hose Set SIL	Set of 8 silicone hoses, ear clamps, glue strips (changing diffuser hoses requires BIO-CEL L-2 Diffuser Tool)
S5	1000001432	BIO-CEL L-2 Adjustable Legs	Set of 4 legs including screws and nuts, Stainless Steel 1.4301/304
	1000001457	BIO-CEL L-2 Adjustable Legs SS316	Set of 4 legs including screws and nuts, Stainless Steel 1.4404/316Ti
S6	1000025076	BIO-CEL L-2 Stack Interconnector Set	Set of 4 interconnectors including screws and nuts, Stainless Steel 1.4301/304
	1000025028	BIO-CEL L-2 Stack Interconnector Set SS316	Set of 4 interconnectors including screws and nuts, Stainless Steel 1.4404/316Ti
S7	1000025034	BIO-CEL L2 Stack Cross Stiffening Set	Set of 2 stiffeners including screws and nuts, Stainless Steel 1.4301/304
	1000025036	BIO-CEL L2 Stack Cross Stiffening Set SS316	Set of 2 stiffeners including screws and nuts, Stainless Steel 1.4404/316Ti
S8	1000025037	BIO-CEL L2 Stack Stiffening Set	Set of 4 stiffeners including screws and nuts, Stainless Steel 1.4301/304
	1000025038	BIO-CEL L2 Stack Stiffening Set	Set of 4 stiffeners including screws and nuts, Stainless Steel 1.4404/316Ti
S9	1000025074	BIO-CEL L-2 Guide Brackets Set	Set of 4 brackets including screws and nuts, Stainless Steel 1.4301/304
	1000024949	BIO-CEL L-2 Guide Brackets Set SS316	Set of 4 brackets including screws and nuts, Stainless Steel 1.4404/316Ti
-	1000001439	BIO-CEL L-2 Diffuser Tool	Pliers for assembly of ear clamps

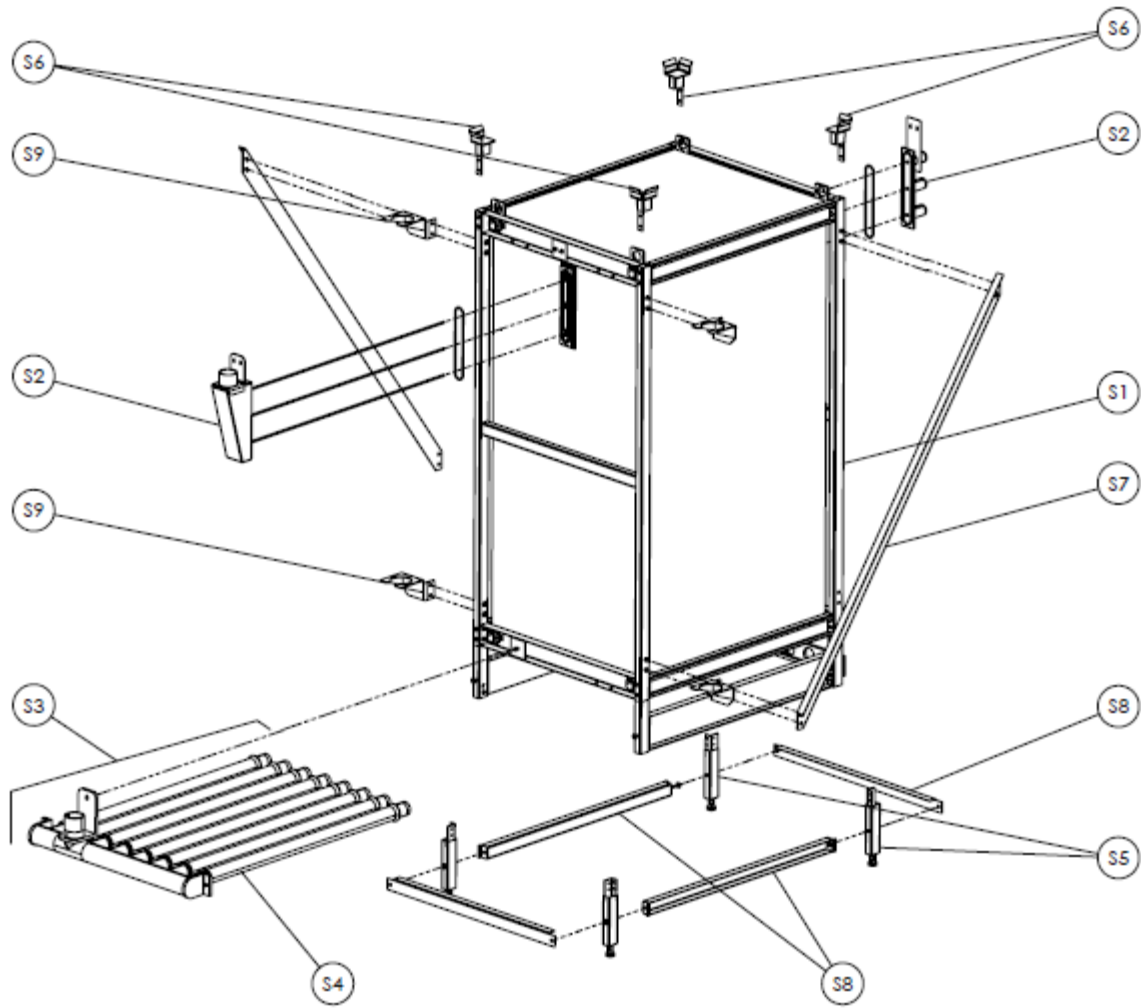

Figure 5. BIO-CEL L-2 Stack spare parts

Contact

Europe

Germany: +49 611 962 6001
Italy: +39 0721 1796201
info.wfs@mann-hummel.com

Americas

USA: +1 805 964 8003
sales.mnus@microdyn-nadir.com

Asia

APAC: +65 6457 7533
info.wfs@mann-hummel.com
China: +86 10 8413 9860
waterchina@mann-hummel.com