

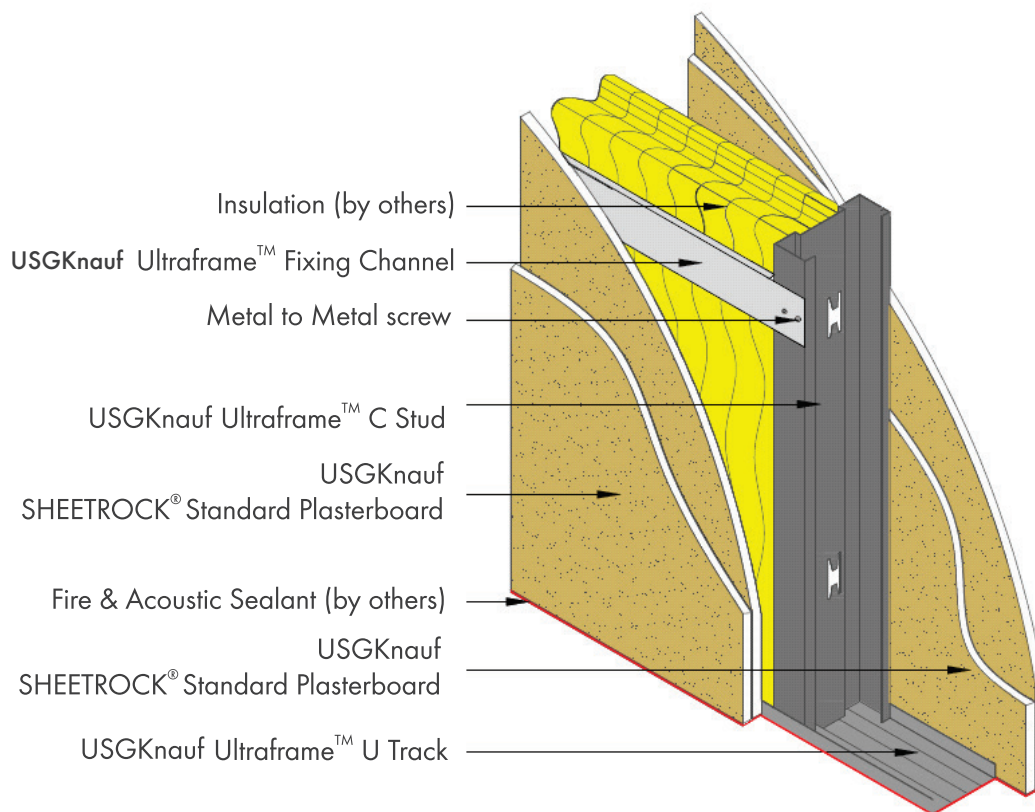

# **USGKnauf Ultraframe™ C Studs**



## Description:

USGKnauf Ultraframe™ C Studs is an integral part of USGKnauf drywalls. This is one of the essential components in drywalls. The plasterboards are secured to it with drywall screws to achieve the desired performance levels.

These are rolled formed on specially designed automatic machines.

## Product Properties:

Description	Unit	Range
Lip (A)	mm	6 (+/- 0.50)
Lip (E)	mm	6 (+/- 0.50)
Flange (B)	mm	36 (+/- 0.50)
Flange (D)	mm	34 (+/- 0.50)
Web (C)	mm	50 / 70 / 90 (+/- 0.50)
Thickness (F)	mm	0.55 / 0.70 (+/- 0.05)
"H" Shape Punch (G)	mm	325 (+/- 5)
"H" Shape Punch (H)	mm	800 (+/- 5)
Standard Length	mm	3050 / 3660 (+/- 5)
Galvanizing	GSM	120 GSM as per IS277
Yield Strength	MPA	Min.230

## Drawing:

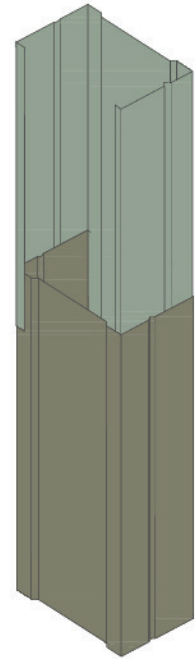
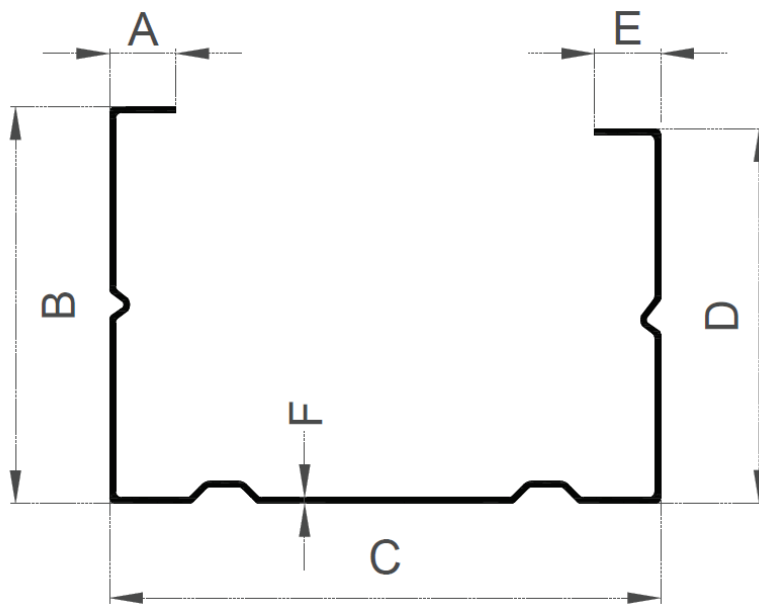

## Drywall USGKnauf Ultraframe™ Framing:

- Ultraframe™ C Studs are friction-fitted into Ultraframe™ floor & ceiling channel.
- C Studs are spaced at 610 mm / 406 mm / 305 mm centers depending upon the design considerations.
- The C Studs have two flanges which are of dimensions 34 mm & 36 mm respectively. This helps to meet the design considerations by creating a box section (as shown) to achieve the stability & overlapping in case of greater heights.

## Safety:

While handling & cutting of Ultraframe™ C Studs, please adhere to the safety guidelines & wear the essential PPE.

### Knauf India Private Limited

**Head Office:** 9<sup>th</sup> Floor, Plaza Tower, DLF Phase -1, Gurugram - 122002, Haryana, India

**Customer Care No:** +91 - 9015147147

**Email:** info.india@knauf.com

[www.usgknauf.com](http://www.usgknauf.com)