

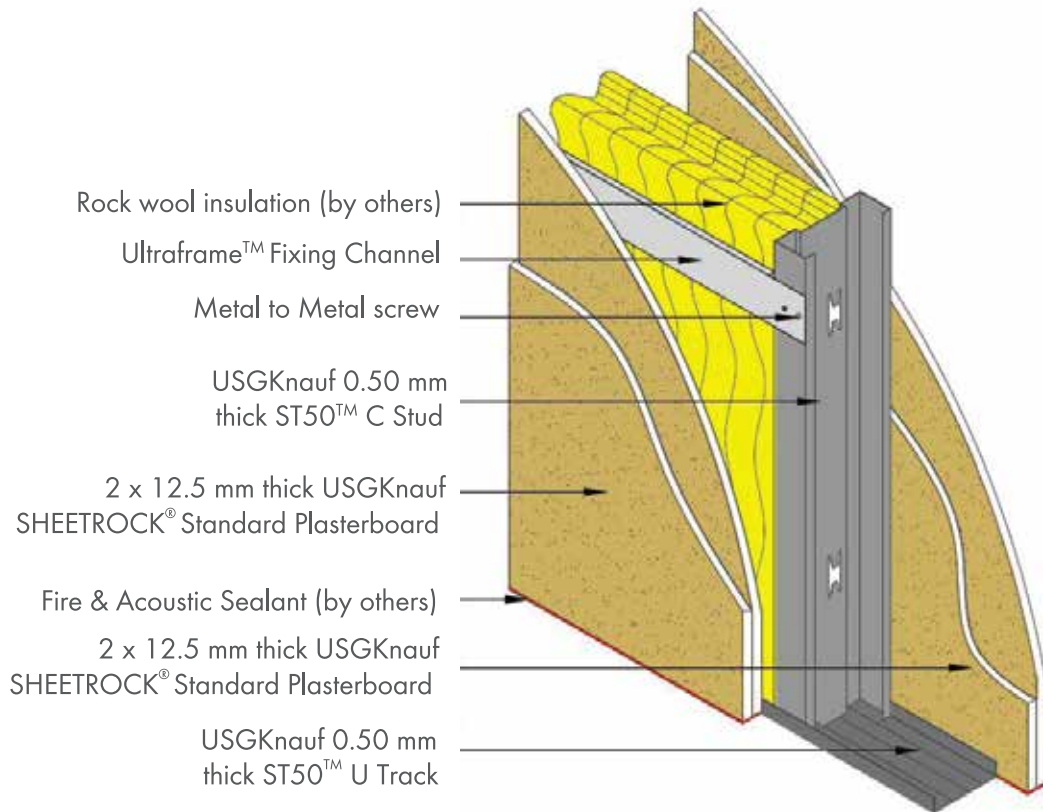

USGKnauf ST50™ C Stud



Description:

USGKnauf ST50™ C Stud is an integral part of USGKnauf drywalls. This is one of the essential components in drywalls. The plasterboards are secured to it with drywall screws to achieve the desired performance levels.

These are rolled formed on specially designed automatic machines.

Product Properties:

Description	Unit	Range
Lip (A)	mm	6 (+/- 0.50)
Lip (E)	mm	6 (+/- 0.50)
Flanges (B)	mm	36 (+/- 0.50)
Flanges (D)	mm	34 (+/- 0.50)
Web (C)	mm	48/70/92/146 (+/- 0.50)
Thickness (F)	mm	48/70 C Stud in 0.50 & 92/146 C Stud in 0.90 (+/- 0.05)
"H" Shape Punch (G)	mm	325 (+/- 5)
"H" Shape Punch (H)	mm	800 (+/- 5)
Standard Length	mm	3660 (+/- 5)
Galvanizing	GSM	120 GSM
Yield Strength	MPA	Min. 230

Drawing:

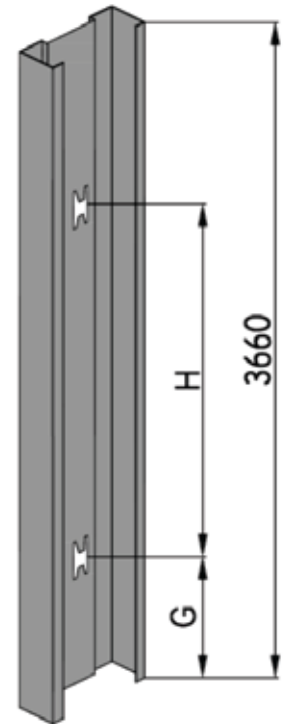
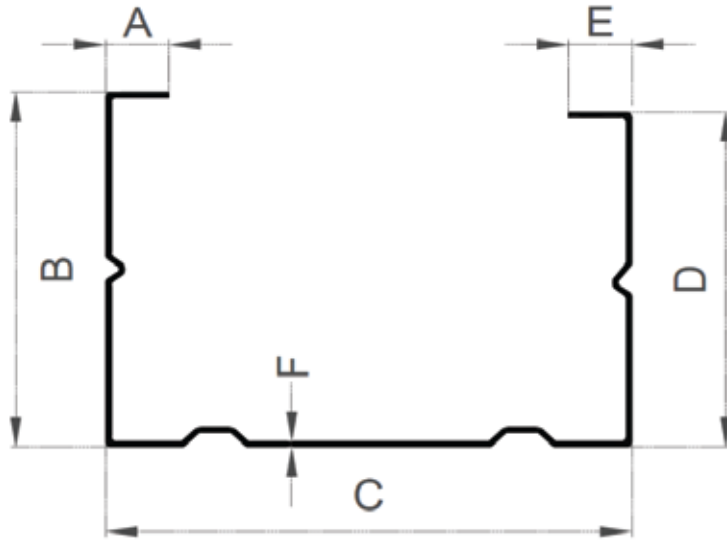

Drywall USGKnauf ST50™ Framing:

- USGKnauf ST50™ C Studs are friction fitted into USGKnauf ST50™ floor & ceiling channel.
- The USGKnauf ST50™ C Studs are spaced at 610 mm/406 mm/305 mm centers depending upon the design considerations.
- The C Studs have two flanges which are of dimensions 34 mm & 36 mm respectively. This helps to meet the design considerations by creating a box section to achieve the stability and overlapping in case of greater heights.

Safety:

While handling & cutting of USGKnauf ST50™ C Studs, please adhere to the safety guidelines & wear the essential PPE.

Knauf India Private Limited

Head Office: 9th Floor Plaza Tower, DLF
Phase-1, Gurugram - 122002, Haryana, India

Customer Care No: +91 - 9015147147
Email: info.india@knauf.com

www.usgknauf.com