

Façade Dowels - DH

April 2021

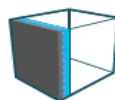

APPLICATIONS



PRODUCT DESCRIPTION

Dowels for fixing thermal insulation in ventilated façade systems

Facade dowel DH is a two - part impact façade dowel for insulation with a thickness range of 60 - 300mm. This two-part dowel consists of a separate wedge and plate (head), thus providing advantages regarding installation and storage

TECHNICAL CHARACTERISTICS

Anchoring depth	≥ 30mm
Drilling depth	≥ 40mm
Drilling diameter	8mm
Plate diameter	90mm

BENEFITS

- Prevented point pressure of insulation by subsequent mounting of the plate
- Reduced packaging space up to 60%
- The installation depth limiter provides a defined mounting regardless of the type of substrate
- High-quality material (plastic) that guarantees safe installation even at large insulation thicknesses

DIMENSIONS AND PACKAGING

Product name	Appropriate Mineral Wool Thickness (mm)	Packaging (pcs.)
Facade plate for dowels: DH Ø90	60-300	300
DH 60	60	300
DH 80	80	300
DH 100	100	300
DH 120	120	300
DH 140	140	300
DH 160	160	300
DH 180	180	300
DH 200	200	300

*Available lengths up to 300mm insulation thickness

CERTIFICATES



Façade Dowels - DH

April 2021

ADDITIONAL INFORMATION

Application

Data on the required number of dowels and their arrangement depend on the used insulation material, position and height of the building and are prescribed by the manufacturer of the ventilated facade system. Recommended insulation thicknesses refer to new facilities and for existing ones it is necessary to take into account and additionally include the thicknesses of existing layers on the facade surface. The dowels are hammered into previously drilled holes.

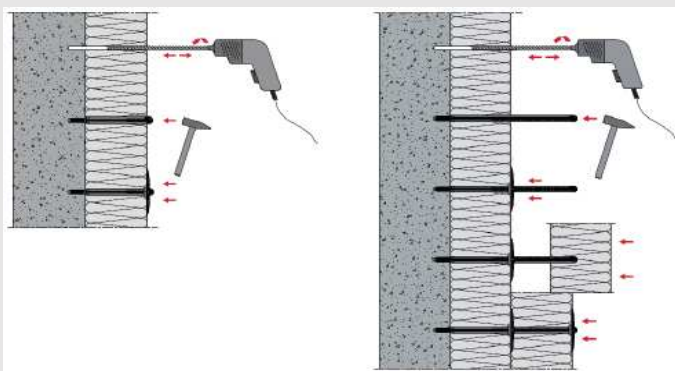

Packaging and Storage

Product is packed in boxes (300 pcs/package). Store boxes packed on a pallet and keep in a dry place, protected from moisture and intense UV rays. They can be safely stored indoors, indefinitely.

Knauf Insulation SA

10 Evripidou str.

176 74 Kallithea

Greece

sales.gr@knaufinsulation.com

Tel.: +30 211 710 7007

Fax.: +30 211 740 9480