

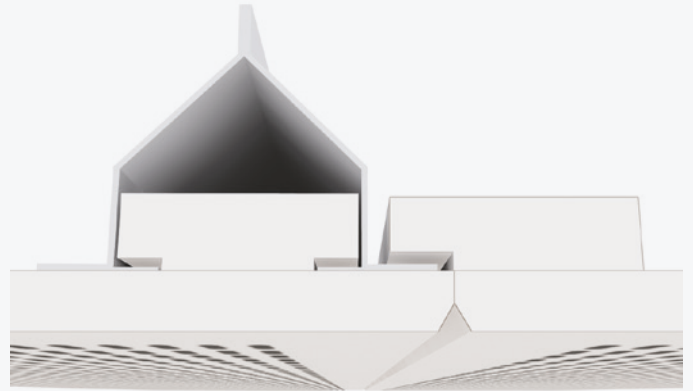

Knauf Corridor 400

Exceptionally fast and easy installation with the self supporting Knauf Corridor 400, with easy access to services, and ideal for corridors and narrow rooms.

Product-Data-Sheet



Areas of Application

Ideal for corridors and narrow rooms.

Compliance Standards

EN14190:2014

Key Benefits

- Self-supporting ceiling
- Free span of up to 2.4 metres
- No suspension grid required, just a flex runner for rigidity
- Can be used in corridors over 2.4 meters by using a T35 main runner

Build on us.

Creation Date: 25/10/2023
Revision Reference: 002
Revision Date: 27/02/2025

Performance Data

Reaction to Fire (R2F)	Stability of Ceiling elements	Flexural Strength
A2-s1, d0	Pass	Pass

Ceiling Sound Absorption

Perforation Type	Alpha-W (α_w) and Sound Absorption Class (@200mm suspension depth, with no mineral wool)
Globe	0.60 - Class C
Micro	0.65 - Class C
Quadril	0.60 - Class C
Tangent	0.80 - Class B

Technical Information

Thickness (mm)	Width (mm)	Length (mm)	Edge Profile	Colour	Weight (kg/m ²)	Perforation Type	Perforation shape & size (mm)	Perforation (%)	Material Number
400	1800	9.5	D	White acrylic paint, RAL 9003, gloss 5	11.7-12.7	Globe	Circles - Ø6 c/c 15	10.6	213297
400	1200	9.5	D	White acrylic paint, RAL 9003, gloss 5	11.7-12.7	Globe	Circles - Ø6 c/c 15	10.6	213295
400	2400	9.5	D	White acrylic paint, RAL 9003, gloss 5	11.7-12.7	Globe	Circles - Ø6 c/c 15	10.6	213299
400	2400	9.5	D	White acrylic paint, RAL 9003, gloss 5	11.7-12.7	Micro	Square - 3x3 c/c 8.33	10.6	213304
400	1800	9.5	D	White acrylic paint, RAL 9003, gloss 5	11.7-12.7	Micro	Square - 3x3 c/c 8.33	10.6	213302
400	1200	9.5	D	White acrylic paint, RAL 9003, gloss 5	11.7-12.7	Micro	Square - 3x3 c/c 8.33	10.6	213300
400	1800	9.5	D	White acrylic paint, RAL 9003, gloss 5	11.7-12.7	Quadril	Square - 3x3 c/c 8.33	14.2	213307
400	2400	9.5	D	White acrylic paint, RAL 9003, gloss 5	11.7-12.7	Quadril	Square - 3x3 c/c 8.33	14.2	213309
400	1200	9.5	D	White acrylic paint, RAL 9003, gloss 5	11.7-12.7	Quadril	Square - 3x3 c/c 8.33	14.2	213305
400	2400	9.5	D	White acrylic paint, RAL 9003, gloss 5	11.7-12.7	Tangent	Obround - 4x14 c/c 10x20	21.3	213314
400	1200	9.5	D	White acrylic paint, RAL 9003, gloss 5	11.7-12.7	Tangent	Obround - 4x14 c/c 10x20	21.3	213310
400	1800	9.5	D	White acrylic paint, RAL 9003, gloss 5	11.7-12.7	Tangent	Obround - 4x14 c/c 10x20	21.3	213312
400	1200	9.5	D	White acrylic paint, RAL 9003, gloss 5	11.7-12.7	Plain	-	-	213290
400	2400	9.5	D	White acrylic paint, RAL 9003, gloss 5	11.7-12.7	Plain	-	-	213294
400	1800	9.5	D	White acrylic paint, RAL 9003, gloss 5	11.7-12.7	Plain	-	-	213292

Sustainability

Recycled Content

Pre-consumer recycled content: 12%

Post-consumer recycled content: 28%

Total recycled content: 40%

2024 average by weight for all acoustic products produced in Denmark, recycled gypsum & paper

Recyclability

This product is fully recyclable when separated from other waste and disposed correctly.

Substances of very high Concern (SVHC)

At the time of publication, under REACH UK and REACH EU regulations this product contains no SVHC. For more information please consult the Safety Data Sheet.

Volatile Organic Compound Content (VOC)

<2 g/L.

Storage and Handling

No special education is required for safe handling. To be stored and used at temperatures below 50°C. Store indoors, in a clean and dry area on a level base protected from direct moisture with humidities of less than 70% RH. Wear clean cotton gloves when handling ceiling tiles to avoid fingermarks.

Packaging

Recycled cardboard wrapping, gypsum tile topper, FSC pallet, and recyclable PE shrink wrap around the pallet.

Service Life

60 years service life. Can withstand:

- constant RH 70% and 25°C
- periodic RH 90% and 30°C
- ambient temperatures of up to 50°C

Disposal/Repair

Dust should be removed using a dry duster or vacuum cleaner. Marks can be removed with a damp cloth. Disposal should be in accordance with local authority requirements. European waste catalogue code: 17 08 02 Gypsum based construction materials, keep apart from waste that comes under 17 08 01.

Health & Safety

Please refer to our Safety Data Sheet for guidance on Personal Protection Equipment required for the handling and installation of this product.

Application / Installation

For full installation instructions please see the installation guide on our website. Install wall angle or shadow line trim. Slide the flex runner over the gypsum runner on the back of the tile, place tile onto the wall angle or shadow line trim. The maximum cut-out, when installing in the centre of the panel is a diameter of 265 mm (e.g. cut-outs for light fittings). The added load should not be greater than 3kg for each m² of ceiling. Where added loads are greater than 3kg/m², additional hangers must be installed.

Additional Documentation

[Declaration of Performance UKCA](#)

[Declaration of Performance CE](#)

[Safety Data Sheet](#)

Certification

[Product Sustainability Credentials](#)

[Product Sustainability Credentials](#)

Product Accreditations:



Knauf UK GmbH Company Accreditations:



The information given in this publication is believed to be current and accurate as at the date of publication, but no warranty, express or implied is given. Updates will not be automatically issued © Copyright Knauf 2024

Customer Service

UK Tel: 0800 521 050

Eire Tel: 01 4620739

Email: cservice@knauf.com

Technical Service

Tel: 0800 521050 (option 2)

Email: technical-uk@knauf.com
(excluding public holidays)

UK Address

Knauf
Kemsley Fields Business Park
Sittingbourne
Kent ME9 8SR

Ireland Address

Knauf
87 Broomhill Road
Tallaght
Dublin 24
D24 WR85

Creation Date: 25/10/2023
Revision Reference: 002
Revision Date: 27/02/2025